

Instructions / Warranty

rior

It is designed to enable you to exert additional pressure on your fingers to slow a running fish.

er From Right Hand Wind

5. Turn the reel from right hand to left hand position, do this by turning the reel at the back of the reel. Turn Drag Knob counter-clockwise (Fig. 2). Remove the spool, remove the screws (Fig. 3). Lift off the plate marked B (Fig. 3). Now, turn the part marked A by twisting the Drag Knob again the same way you turn the center Disc Unit marked E and replace it (Fig. 4). Put back the top brake shoe (D) and keeping the top brake knob back (C) ready to accept the spool. Replace the retaining screws (A).



Figure 4



ing and

shown on the right
to the reel. To
to the fly
in Albright or a
are illustrated in Scientific Anglers' "Pock-
with each Scientific Anglers Fly Line.



are Parts

ntly service on your reel, send it well packed, post-
to:

Scientific Anglers/3M
100 James Savage Road
Midland, Michigan 48660

Anglers Weight Forward Fly Line and a specific amount of 20 lb. test backing capacity for all reel sizes available. Be sure to leave approximately 1/8" clearance between the last coil of fly line and the spool rim to insure easy removal and replacement of the spool. It is important to wind the backing and fly line on the spool tightly and evenly.

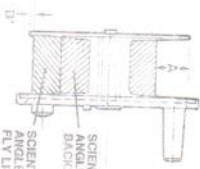
[illegible]

2000

	29 Lbs. S.A. Bucking (Yards)	3 rd (Elimination Index)
WT 7-F	400	3/8
WT 8-F	375	7/16
WT 9-F	330	1/2
WT 10-F	250	1/2
DT 7-F	290	9/16
DT 8-F	240	5/8
DT 9-F	190	3/4
DT 10-F	130	13/16

Model 1011
Line Capacity

	20 Lbs.		30 Lbs.	
	5.5 Picking (yards)	Dimension (inches)	5.5 Picking (yards)	Dimension (inches)
Fl. line				
Line height				
Wt 9 f	5.0	3.0	3.0	7/16
Wt 10 f	4.40	7/16	2/5	7/16
Wt 11 f	3.80	9/16	2.40	9/16
Wt 12 f SMT	3.30	9/16	2.10	9/16
D1 9 f	3.10	9/16	2.20	9/16
D1 10 f	2.50	5/8	1.75	5/8

with proper amount of dressing and fly line.

Care and Maintenance of Reel

Your reel is designed to last for years of normal fishing given reasonable care.

required after each use. After each rinsing apply to the shaft a thin coat of silicone or teflon based grease. Avoid any kind of lubricant on both sides of the disk. For smooth drag operation it is important that no lubricant is on disc or pads.

Limited Warranty

On the warranty, we warrant this product against any defects in materials and workmanship for a period of one year from the date of purchase. In the event the product is found to be defective within the warranty period, Scientific Angles/SM will replace or refund the purchase price of the product at our option within a reasonable time after notification.

To obtain warranty service, please send your reel post-paid and insured to the address above. Include your name, address, zip code, date of purchase, purchase price, model number, and a description of any defects.

His warranty gives you specific legal rights, and you may also have other rights which may vary from state to state.

Scientific Anglers/3M

3M Center
St. Paul, MN 55144



Real Model 67 (B.F.R. 471)

Part No.	Description
1	U-534 Drag Knob
2	S-075 Drag Knob Spring
3	O-490 Drag Click Ball
4	U-520 Body
5	P-198 Line Guard
6	T-253 Line Guard Screw
7	O-488 Drag Knob Retainer
8	U-544 Bottom Brake Assembly
9	U-544 'O' Ring Retainer
10	U-529 Top Brake Plate
11	P-190 Brake Retainer
12	T-249 Click Pawl Spindle
13	M-493 Click Pawl Slider
14	P-197 Click Pawl
15	P-202 Click Pawl Cover
16	W-019 Cover Retaining Screw
17	U-531 Disc
18	W-001 Retaining Screw
19	C-275 Spool Drive Plate
20	S-074 Compression Spring
21	U-528 Release Lever
22	P-090 Felt Pad
23	T-250 Quick Release Cover
24A	U-524 Spool
25	C-289 Foot
26	W-021 Foot Screw
28-24A	Spool Assembly

Reel Model 89 (B.F.R. 473)

No.	B.F.R. Part No.	Description
1		11500

2	D-835	Drag Knob
3	S-075	Drag Knob Spring
4	O-490	Drag Click Ball
5	U-522	Body
6	P-199	Line Guard
7	T-253	Line Guard Screw
8	U-545	Drag Knob Retainer
9	O-488	Bottom Brake Assembly
10	O-469	O' Ring Retainer
11	U-532	Top Brake Plate
12	P-190	Brake Retainer
13	T-249	Click Pawl Spindle
14	M-493	Click Pawl Slider
15	P-197	Click Pawl
16	P-202	Click Pawl Cover
17	W-019	Cover Retaining Screw
18	U-531	Disc
19	W-001	Retaining Screw
20	C-275	Spool Drive Plate
21	S-074	Compression Spring
22	U-528	Release Lever
23	P-090	Felt Pad
24B	T-250	Quick Release Cover
25	U-526	Spool
26	C-289	Foot
44/73	W-021	Foot Screw
13-24B		Spool Assembly

Reel Model 78 (B.F.R. 472)

No.	B.F.R. Part No.	Description
1	U-534	Drag Knob
2	S-075	Drag Knob Spring
3	O-490	Drag Click Ball
4	U-521	Body
5	P-199	Line Guard
6	T-253	Line Guard Screw
7	O-498	Drag Knob Retainer
8	U-544	Bottom Brake Retainer
9	O-489	O' Ring Retainer
10	U-529	Top Brake Plate
11	P-190	Brake Retainer
12	T-249	Click Pawl Spindle
13	M-193	Click Pawl Slider
14	P-197	Click Pawl
15	P-202	Click Pawl Cover
16	W-019	Cover Retaining Screw
17	U-531	Disc
18	W-001	Retaining Screw
19	C-275	Spool Drive Plate
20	S-074	Compression Spring
21	U-528	Release Lever
22	P-090	Felt Pad
23	T-250	Quick Release Cover
24A	U-525	Spool
25	C-289	Foot
26	W-021	Foot Screw
24A	4472	Spool Assembly

Steel Model 1011 (B.F.F.R. 474)

No.	B.F.R. Part No.	Description
1	U-535	Drag Knob
2	S-075	Drag Knob Spring
3	O-490	Drag Click Ball
4	U-523	Body
5	P-200	Line Guard
6	T-253	Line Guard Screw
7	O-488	Drag Knob Retainer
8	U-545	Bottom Brake Assembly
9	O-489	O Ring Retainer
10	U-552	Top Brake Plate
11	P-190	Brake Retainer
12	T-249	Click Pawl Spring
13	M-483	Click Pawl Slider
14	P-197	Click Pawl
15	P-202	Click Pawl Cover
16	W-019	Cover Retaining Screw
17	U-531	Disc
18	W-001	Retaining Screw
19	C-275	Spool Drive Plate
20	S-074	Compression Spring
21	U-528	Release Lever
22	P-090	Fell Pad
23	T-250	Quick Release Cover
24B	U-527	Spool
25	C-286	Foot
26	W-021	Foot Screw

Spool Assembly

Scientific Anglers
System 2 ~ 1997
Sheet No: 12B

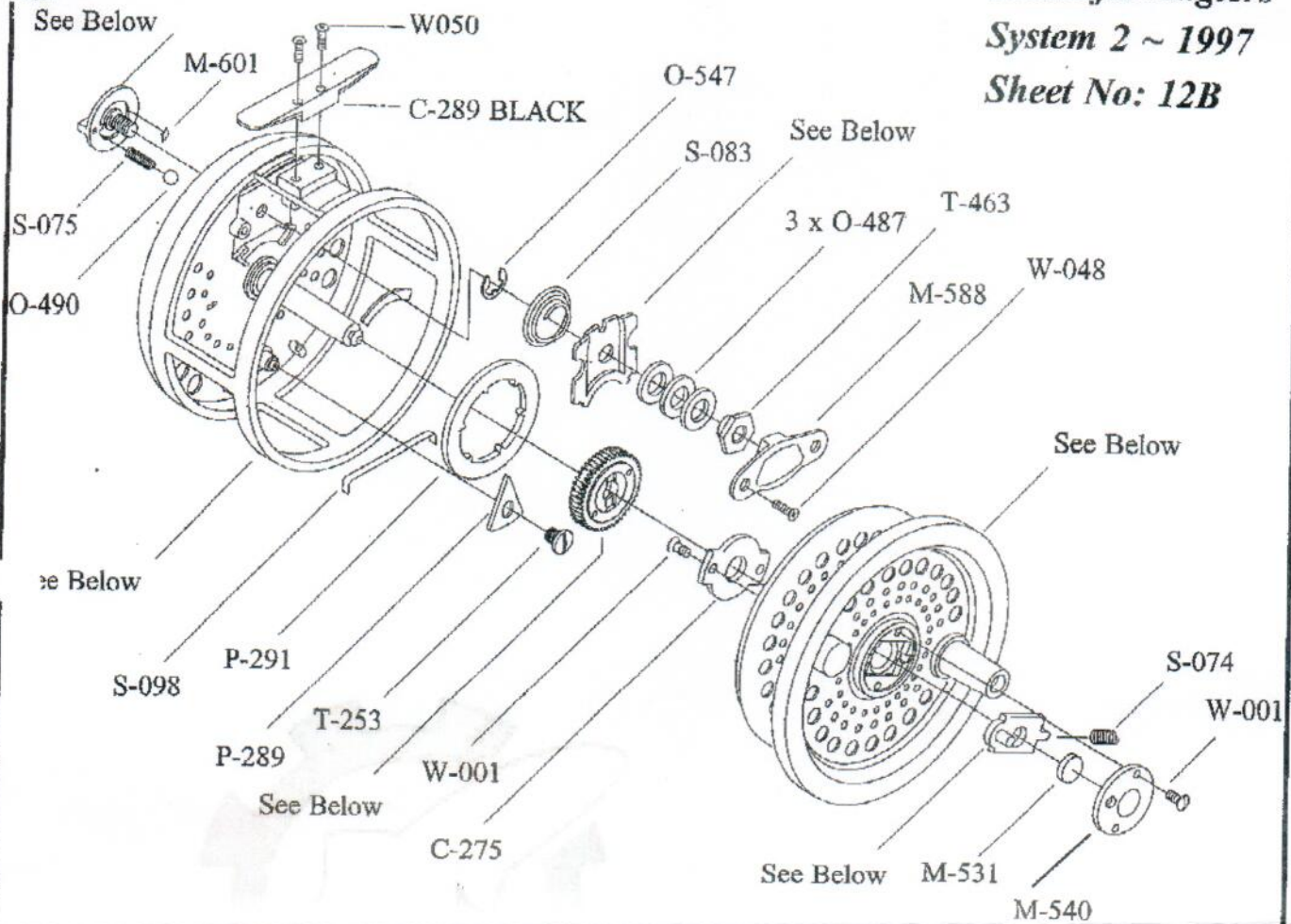

MODEL	78	89	1011	1213
PRODUCT No.	405	406	407	408
BODY S/A	U723	U724	U725	U726
BODY	C480	C481	C482	C483
CENTRE SPINDLE	T241	T262	T242	T347
FOOT	C289 BLACK			
FOOT SCREW	W050			
SPINDLE WASHER	T243			

SA2 1011 & 1213 CAN BE SUPPLIED WITH C-360
 BLACK FOOT IF REQUIRED

SPOOL ASSEMBLY	405SA	406SA	407SA	408SA
SPOOL S/A	U525	U526	U527	U593
SPOOL FRONT	C273	C277	C279	C347
SPOOL REAR	C274	C280	C280	C348
HANDLE KNOB	M495			
OILITE BEARING	O494	O495		
COUNTER WEIGHT	T407	T419		
KNOB SHEILD	T228			
KNOB SPIGOT	T254			

GEAR S/A	U-729
RATCHET PAWL	P-223
RATCHET PAWL SPRING	S-086
DRIVE GEAR BODY	T-461
DRIVE GEAR COVER	M-589
RATCHET WHEEL	T-462
RETAINER	O-529
RIVET	T-303

DRAG KNOB S/A	U-730
DRAG KNOB INSERT	T-464

RELEASE LEVER S/A	U-528
RELEASE KNOB	T-244
RELEASE PLATE	P-189

BRAKE PLATE S/A	U-619
BRAKE PAD	P-260
BRAKE PLATE	P-259
ADHESIVE	O-483